

Secretary  
Member B.P.C.  
Chairman B.P.C.

AD SD ATP

Check and find for Public Health (Internal Services only) subject to comments in following letter No SEHQ/24a/CL/13/11/11  
Sudhakar S Engineer (E) PUDA Parbhani

PLUMBING NOTES:-	
1.	
2.	KITCHEN SINK TO FLOOR TRAP FLEXIBLE PIPE.
3.	FLOOR DRAIN (FD) TO FLOOR TRAP (FT) 63 OD UPVC WASTE PIPE.
4.	110 OD UPVC PIPE USED FOR SOIL & WASTE.
5.	110 OD UPVC PIPE USED FOR TERRACE RAIN WATER
6.	90 OD UPVC PIPE USED FOR BALCONY.
SCHEDULE OF PIPES :-	
PIPE NO.	DESCRIPTION
①	110 OD UPVC SOIL & VENT PIPE
②	110 OD UPVC WASTE & VENT PIPE
③	75 OD UPVC ANTI-SYPHONAGE PIPE
④	110 OD UPVC TERRACE RAIN WATER PIPE
⑤	90 OD UPVC BALCONY RAIN WATER PIPE
⑥	DOMESTIC WATER SUPPLY D/N TAKE PIPE
⑦	FLUSHING WATER SUPPLY D/N TAKE PIPE
⑧	DOMESTIC WATER SUPPLY RISER *
⑨	FLUSHING WATER SUPPLY RISER *
⑩	HOT WATER SUPPLY D/N TAKE PIPE FROM SOLAR PANEL
⑪	DOMESTIC WATER SUPPLY D/N TAKE PIPE FOR TOP 4TH FLOOR
FT	FLOOR TRAP (110x110) MM
FD	FLOOR DRAIN (110x63) MM
BD	BALCONY DRAIN (110x63) MM
BT	BATH TUB TRAP
OD	OUTER DIA OF PIPE

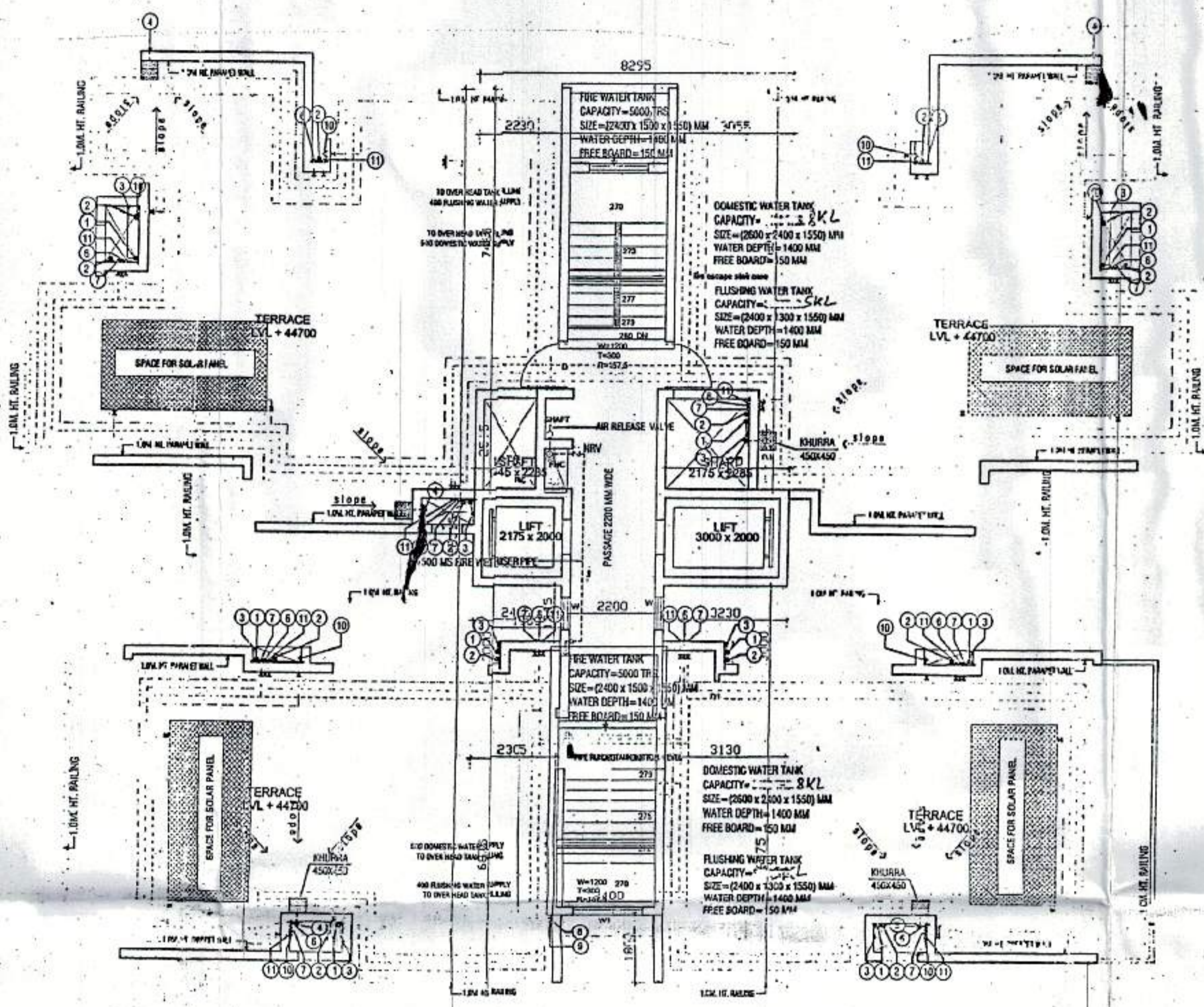

MUMTY/TERRACE FLOOR PLAN

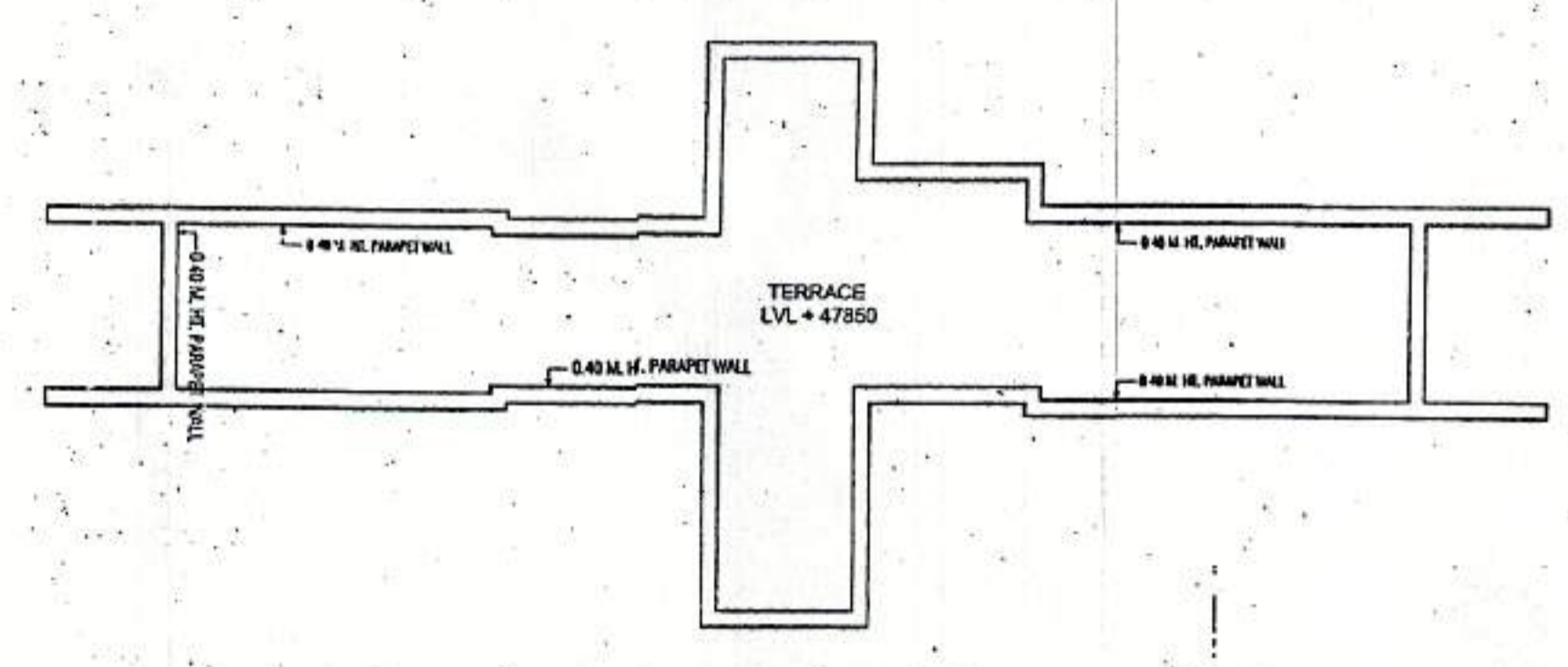

MUMTY/TERRACE PLAN

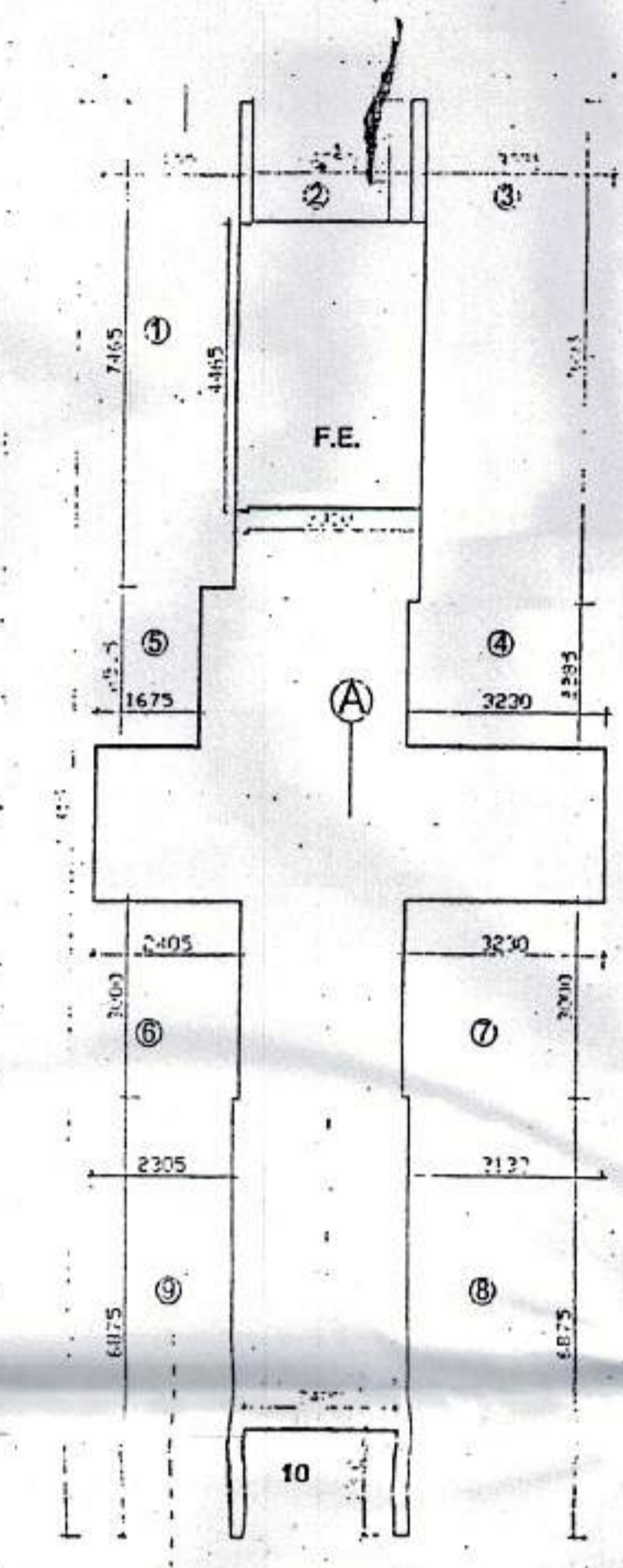

MUMTY AREA DIAGRAM

A	= 8.295 x 22.315	= 185.102
1	= 2.230 x 7.485	= 16.646
2	= 2.550 x 1.800	= 4.59
3	= 3.055 x 7.695	= 23.508
4	= 3.230 x 2.285	= 7.380
5	= 1.875 x 2.515	= 4.712
6	= 2.405 x 3.000	= 7.215
7	= 3.230 x 3.000	= 9.69
8	= 3.130 x 6.875	= 21.518
9	= 2.305 x 6.875	= 15.846
10	= 2.430 x 1.800	= 4.32
F.E.	= 2.450 x 4.465	= 11.385
TOTAL DEDUCTION		= 126.31 SQM.
MUMTY COVD. AREA		= 185.102 - 126.364
		= 58.792 SQM. (NON F.A.R.)

PROPOSED COVERAGE	
GROUND FLOOR AREA	= 457.216 SQM. (F.A.R. AREA)
FIRST FLOOR COVD. AREA	= 424.082 SQM. (F.A.R. AREA)
SECOND FLOOR COVD. AREA	= 424.082 SQM. (F.A.R. AREA)
THIRD FLOOR COVD. AREA	= 424.082 SQM. (F.A.R. AREA)
FOURTH FLOOR COVD. AREA	= 424.082 SQM. (F.A.R. AREA)
FIFTH FLOOR COVD. AREA	= 424.082 SQM. (F.A.R. AREA)
SIXTH FLOOR COVD. AREA	= 424.082 SQM. (F.A.R. AREA)
SEVENTH FLOOR COVD. AREA	= 424.082 SQM. (F.A.R. AREA)
EIGHTH FLOOR COVD. AREA	= 424.082 SQM. (F.A.R. AREA)
NINETH FLOOR COVD. AREA	= 424.082 SQM. (F.A.R. AREA)
TENTH FLOOR COVD. AREA	= 424.082 SQM. (F.A.R. AREA)
ELEVENTH FLOOR COVD. AREA	= 424.082 SQM. (F.A.R. AREA)
TWELFTH FLOOR COVD. AREA	= 424.082 SQM. (F.A.R. AREA)
THIRTEENTH FLOOR COVD. AREA	= 424.082 SQM. (F.A.R. AREA)
MUMTY/MACHINE ROOM AREA	= 58.792 SQM. (NON F.A.R. AREA)
ACHIVED F.A.R. AREA	= 5970.282 SQM.
TOTAL NON F.A.R. AREA	= 159.39 + 58.792 = 218.182 SQM.

DOORS + WINDOWS SCHEDULE:	
DW = 2400 x 2600	DW/EF = 2415 x 2600
DW1 = 2500 x 2600	W = 900 x 2300
DW2 = 1455 x 2600	W1 = 1800 x 2300
DW3 = 2600x 2600	VPV = 800 x 1400
DW4 = 4000x 2600	EF = 460 DIA
DW5 = 1650x 2600	
D = 1000x 2600	
D1 = 750 x 2600	

OWNERS SIGN: For Shivnandan Buildtech Pvt. Ltd.  
ARCHITECT'S SIGN: ARCHITECT RAJESH JAIN  
Authorised Signatory CA/21/13/73

Project: PROPOSED GROUP HOUSING COLONY  
MEASURING 12.031 ACRE LICENCE NO. 70 OF 2011  
DATED 22.07.2011 IN SECTOR -99, GURGAON  
MANESAR URBAN COMPLEX.  
Client: M/S SHIVNANDAN BUILTECH PVT. LTD

DATE: 13.11.11  
DRAWN: RAJ  
CHECKED: P.J.  
APPROVED: P.J.  
PAGE: 11/24 REV: 00

ARCHITECT: Ichinen ARCHITECTS PRIVATE LIMITED  
A-5 SARVODAYA PARK ANP, NEW DELHI-110017  
TELEFAX -91 11 46099600, EMAIL: ichinen@ichinenindia.com